

# PLAN DE INCADRARE IN TARLA

Scara 1:1000  
Sistem STEREO 70

Loc. GURGHIU, UAT. GURGHIU  
TARLA 67, A 4647, F 4646

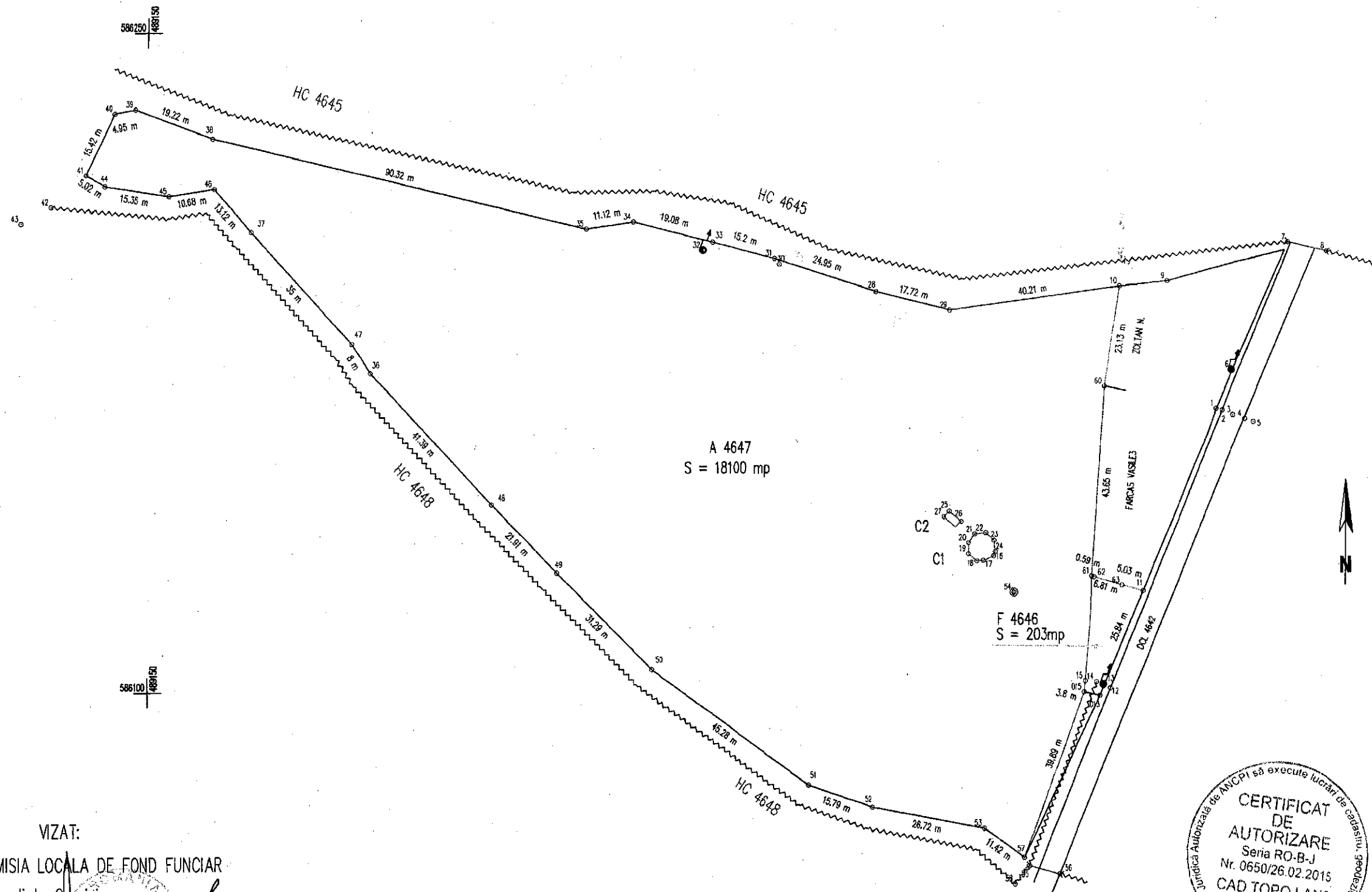

VIZAT:  
COMISIA LOCALA DE FOND FUNCAR

Presedinte Comisie:  
*[Signature]*

Data: 06.2020  
Stampila

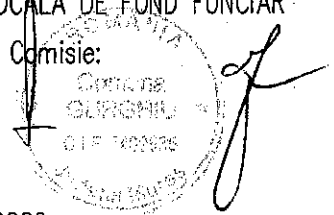

Proprietar:  
COMUNA GURGHIU



Executat:  
SC CAD TOPO LAND SRL  
ing. IOJA IOAN